



CONTOUR CONSOLE

2012-2016 FORD F-250 - 550 DASH MOUNT CONTOUR CONSOLE

Installation Instructions

425-6271



Remove panel below steering column. Gently pry up from the bottom.



Use a flat head screwdriver to remove the left and right corners of the dash.



Unplug the components from the corner panels.

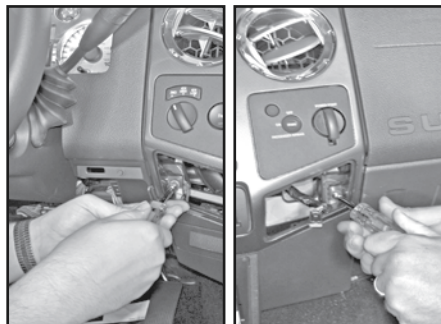

Remove the screws from the left and right side behind the corner panels.



Gently pull the panel off of the dash.



Unplug the components from the panel.

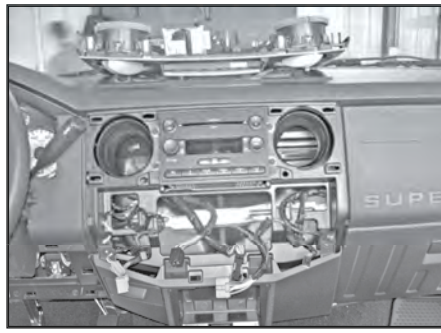

Set the panel aside.

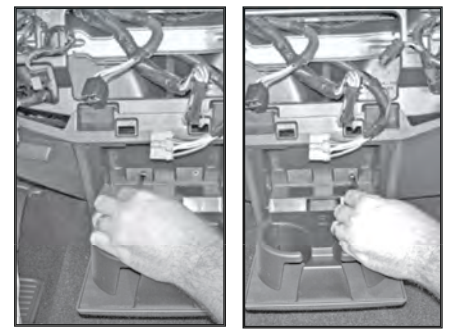

Lower the cup holder and remove the 2 screws.

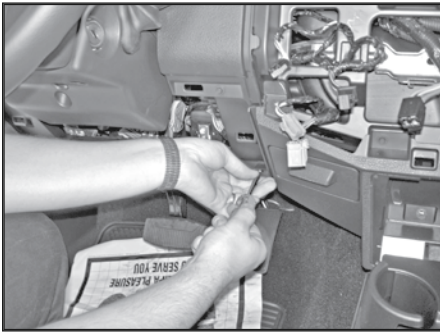

Remove the screw from the left side of the panel.

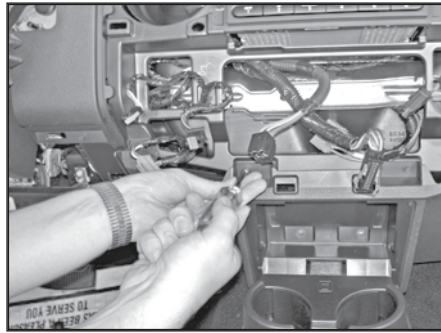

Remove the two center screws on the panel.

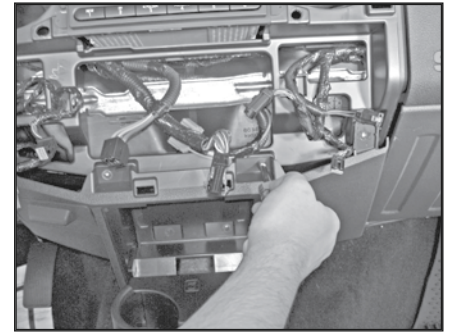

Gently pry the lower panel off and remove and set aside.

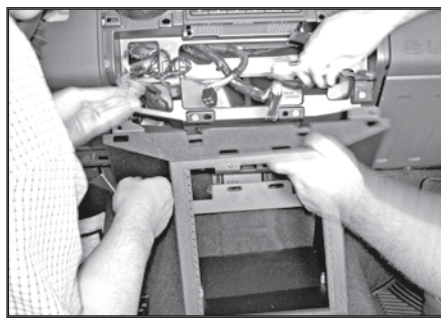

Line up Contour Console with holes on dash.
***Optional Airbag On/Off Switch Relocation See Last Page**

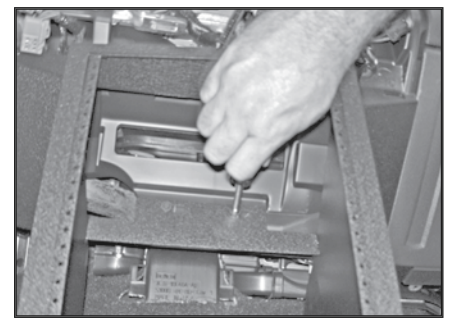

Place the two screws back into lower center holes.(but do not tighten down)

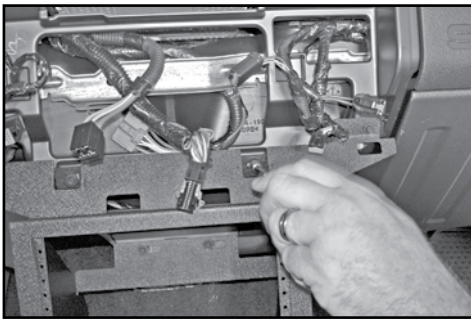

Replace 2 screws into upper center holes. (but do not tighten down)

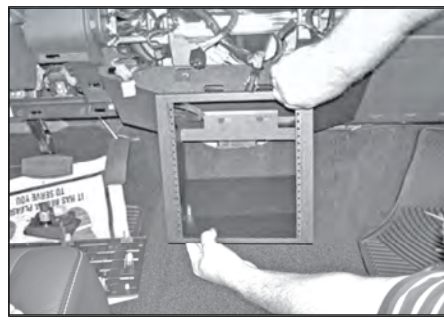

Shift console into place. Be sure outer holes line up (see pic). Now tighten down all four screws from step 14 and 15.

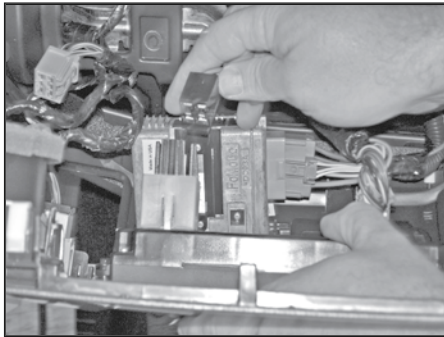
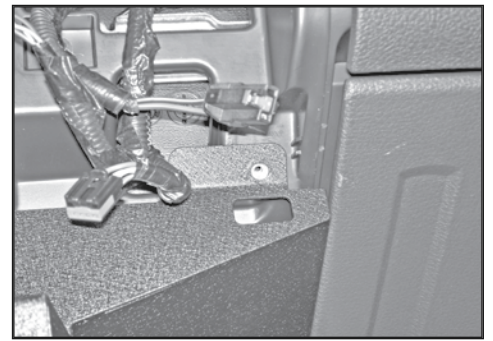

Replace all connectors into the upper panel

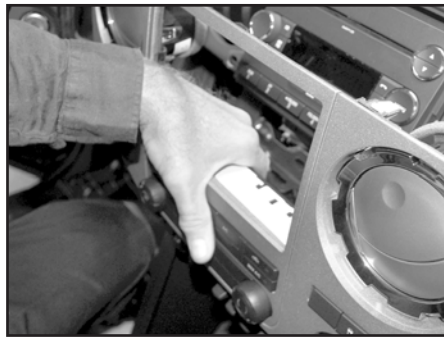

Setting the OEM upper dash trim back into position. Reach through the radio opening and press down on the metal clip of the OEM brake controller.



Slide OEM upper dash trim into place. Make sure the clip goes under the OEM dash frame as shown.



Once the clip is started into place. Then push OEM console back into the original position with an upward and forward motion.



Place the upper panel back on to the dash.



Replace the 2 screws located behind the 2 corner panels.

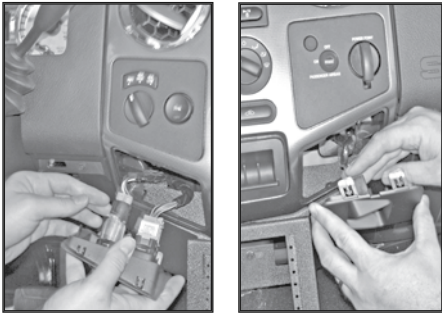

Reconnect the components to the small corner panels.

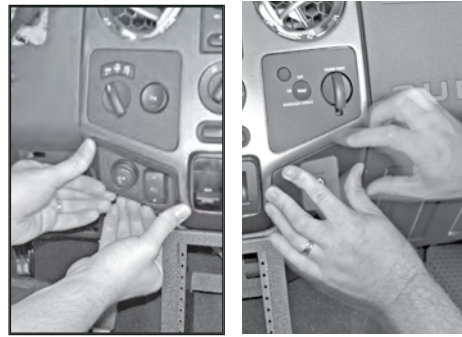

Replace the bottom corner panels.



Replace the screw on the left side of the console and replace the panel under the steering column.



CONGRATULATIONS!!!

Your install is now complete and ready for faceplate and equipment mounting...

***Optional Airbag On/Off Switch Relocation**

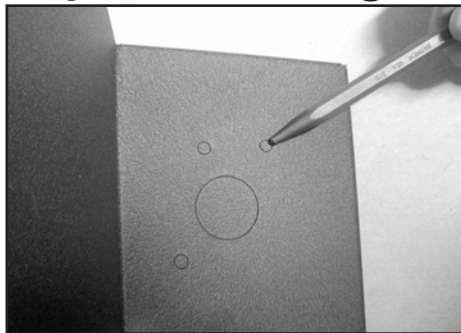

Using a punch knock out all 4 stamped holes on drivers side of console.

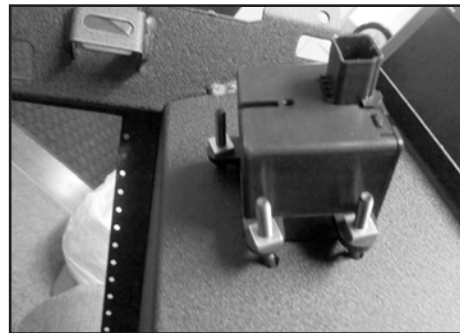

Attach airbag on/off switch. We suggest using (3) 10-24 x 1.5 screws and (3) 10-24 nuts.

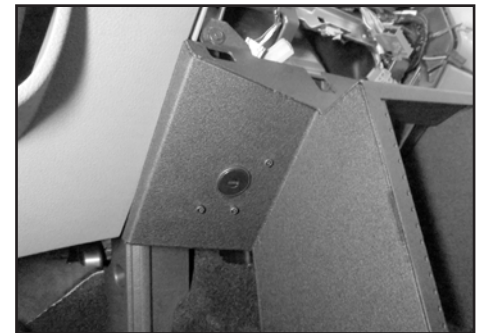

You are now ready to continue install instructions.

If you have questions or need further assistance please call Technical Support: 1.877.455.6886



209 W. EASY ST., ROGERS, AR 72756 • JOTTOPUBLICSAFETY.COM • 2/25

Jotto Desk™ is a patented product and Registered Trademark of Assembled Products™ Corporation.
Specifications subject to change without notice.

050-0172-00

