



425-6500
Ford F-150 SSV/PR (18-20)
Ford F-250-550 (18+)

Installation Instructions

NOTE: If you choose to relocate OEM USB power connector, see Steps 1-8 before installing Floor Plate and Console.



Unsnap speaker cover from each side corner to remove (2) 7mm screws.



Pry the top tray up from each front corner and remove the (2) 7mm screws. Unplug speaker from the harness.



Pry from the top to unsnap the trim covering the radio and climate controls. Unplug the heater control from the harness.



Remove (1) 10mm screw holding the lower trim in place rotate over the transmission hump and unsnap from the passenger side.



Remove lower panel containing 12 volt power and USB by unscrewing (2) 7mm screws on the top and (2) 10mm screws on the bottom. Unplug accessories from harness.

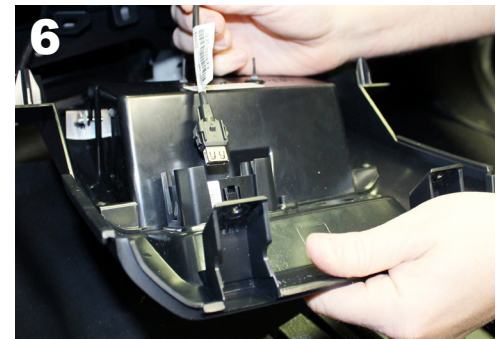

Unclip USB cable from dash port. Trace the cable back and find where it is tied to the wiring harness. Free the attached point to allow enough cable length for relocation of USB.



Relocate USB into storage box of Contour Console. Snap USB port into Console. Plug in USB cable.

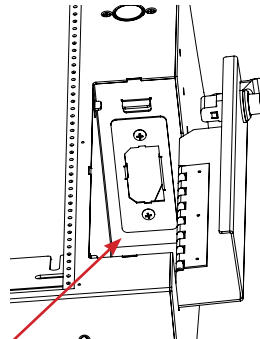

At this point, reinstall all OEM dash components except for the USB which was just relocated into the Console on the previous step.

Begin Installing Floor Plate
(See next page for instructions)

NOTE: If vehicle has 40/20/40 seats: Remove the center seat, unplug 12v power supply, remove OEM mounting brackets on floor board (see picture below) and proceed with install.

If installing in a Police Responder: Remove OEM mounting brackets on floor board (see picture below) and proceed with install.



Remove (2) OEM mounting brackets.

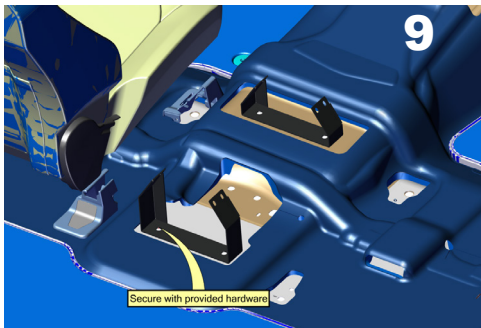

Place front and rear Floor Plate Brackets over hole locations. Secure with provided bolts or OEM hardware.

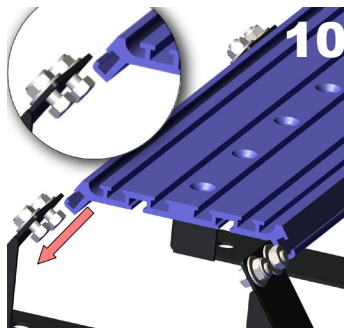

Lightly secure (8) of the 5/16-18 bolts, washers, and nuts to the Floor Plate Brackets. Slide the Floor Plate in from the rear, aligning the bolts with the side grooves on the Floor Plate side.

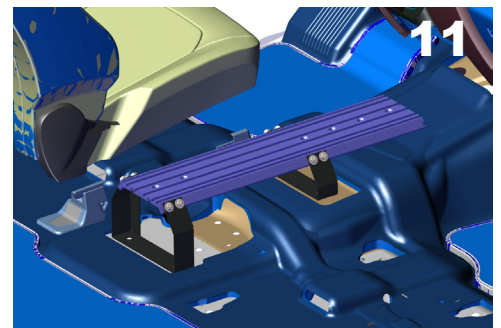

Place the Floor Plate in desired location by sliding forward and back. Secure by tightening the 5/16 nuts.



Place Console on Floor Plate making sure Console slides up against the dash and secure in place.

If you have questions or need further assistance please call Technical Support: 1.877.455.6886



209 W. EASY ST., ROGERS, AR 72756 • jottopublicsafety.com • 10/20

Jotto Desk® is a patented product and Registered Trademark of Assembled Products™ Corporation.
Specifications subject to change without notice.