



WINDOW ARMOR

FORD F-150 SSV (2016+) | F-150 POLICE RESPONDER (2018+) | F-250 (2019+)

Installation Instructions

475-1167/475-1168/475-9181

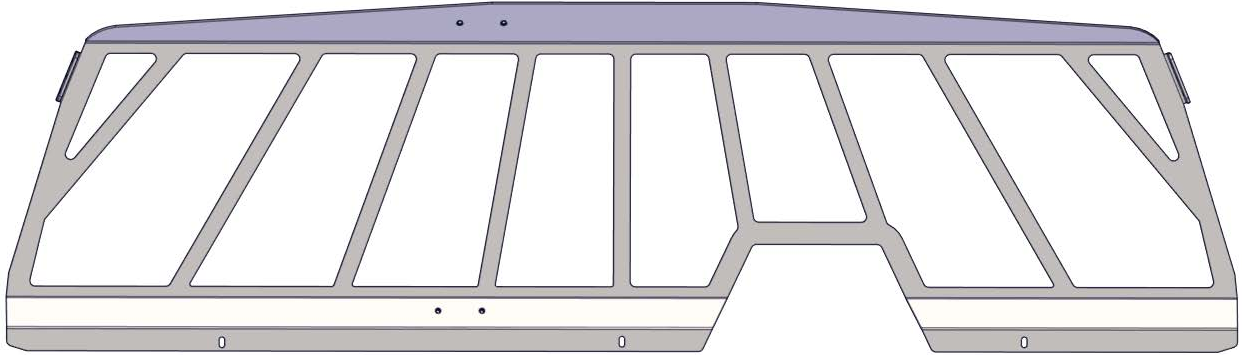

Rear Window Armor



DS Side Mount Bracket

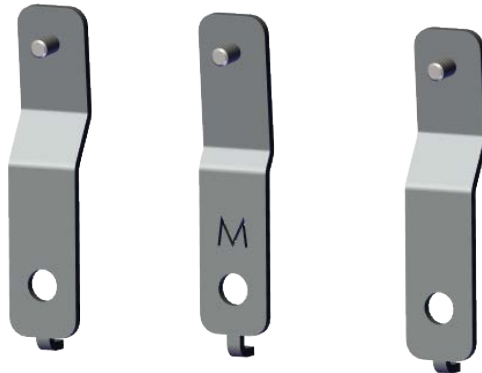

Lower Mount Brackets



PS Side Mount Bracket



DS Door Window Armor



PS Door Window Armor



Bracket Adaptors

*Rear Window Steps



1. Fold PS rear seat forward by using pull strap.



2. Fold DS rear seat by raising up on the seat cushion this allows you to access rear bracket and depress lever on bracket to release seat and fold forward.



3. Pull insulation forward to remove (3) 13 mm OEM bolts from child restraint loops.



4. Loosely attach Lower Brackets into place using the previously removed (3) 13 mm OEM bolts.



5. You will need to remove the weather stripping from rear doors to be able to remove the "C" pillar OEM trim.



6. Remove "C" pillar OEM trim by carefully pulling trim away from frame. Once the trim is away from frame, remove plastic wire clip behind trim keeping it from falling.



7. Cut the (3) ribs from each side of "C" pillar OEM trim.

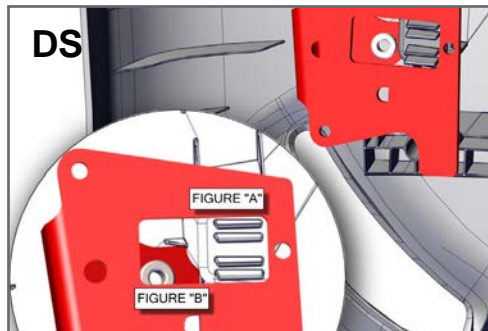

8. With the DS/PS "C" pillar trim removed, place the designated Side Mount Bracket on the back side of the OEM trim. Adjust the Bracket to sit squarely within the trims extruded boss (Figure "A") and secured around the curve of the bottom (Figure "B"). Mark a hole through the Brackets pem nut and drill a 1/8 hole followed by a 3/8 hole.

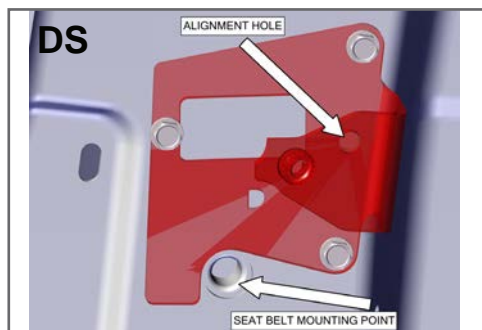
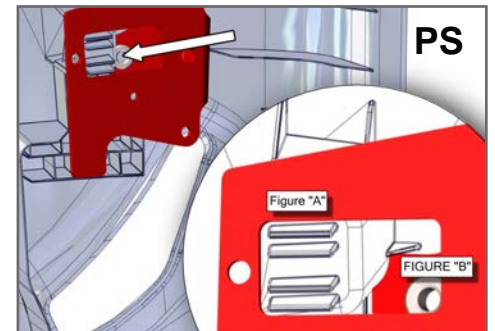

9. Using the slot on the bracket, slide behind seat belt bolt and use the hole closest to door jam and align with OEM hole. Once in proper position, secure Side Mount Brackets to frame using provided (3) Tek screws.

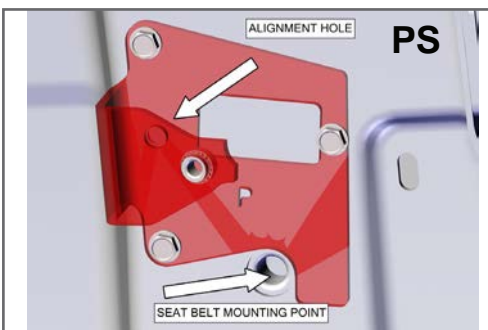

10. Replace OEM "C" pillar trim, weather stripping and tighten the (3) Lower Brackets.

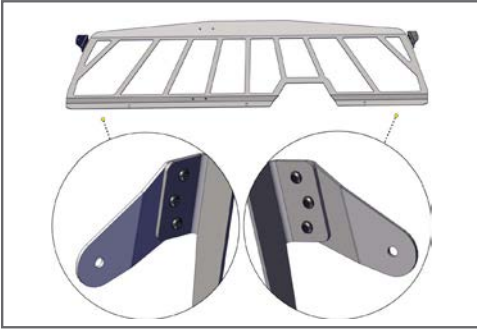

11. Secure the Adaptor Brackets to the Rear Window Armor with provided hardware (**A small drop of Loctite recommended but not required**). **Do not over tighten screws.**



12. Secure Rear Window Armor to all brackets using provided (3) flange nuts on Lower Brackets and (6) Tek screws on Side Brackets. Once Window is in position, tighten all hardware.

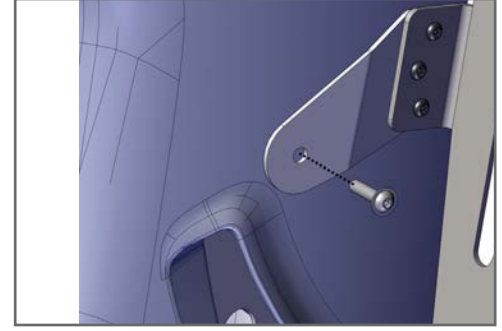

13. Attach the Adaptor Brackets to the DS/PS Side Brackets through the previously drilled hole with provided hardware.

****Door Window Armor Steps***

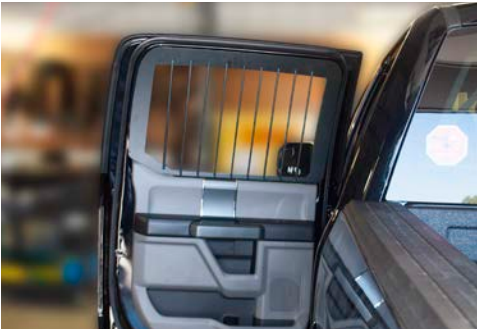

Align Door Window Armor into position following contour of door frame. Secure Window Armor into place using provided Tek screws.

If you have questions or need further assistance please call Technical Support: 1.877.455.6886



209 W. EASY ST., ROGERS, AR 72756 • JOTTOPUBLICSAFETY.COM • 6/23

Jotto Desk™ is a patented product and Registered Trademark of Assembled Products™ Corporation.
Specifications subject to change without notice.