

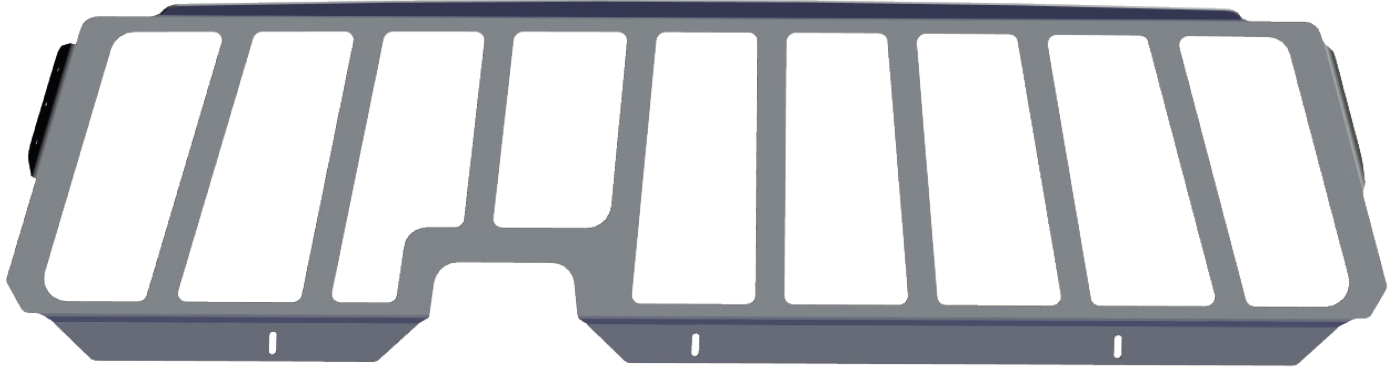

WINDOW ARMOR  
INSTALLATION INSTRUCTIONS  
'15-'19 DODGE RAM SSV



Rear Window Armor



D/S Side Mount Bracket

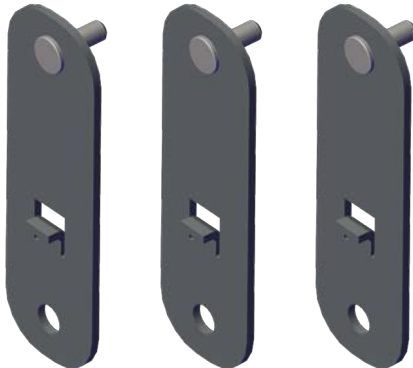

Lower Mount Brackets



P/S Side Mount Bracket

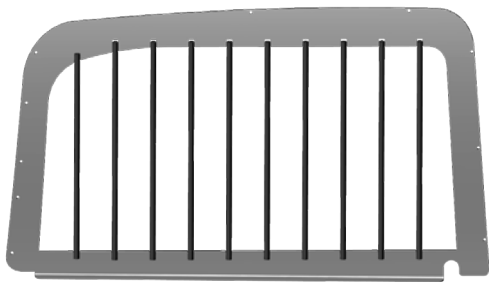

D/S Door Window Armor

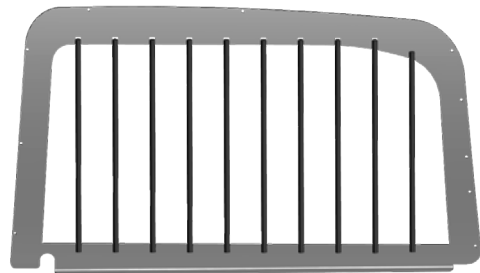

P/S Door Window Armor



# WINDOW ARMOR INSTALLATION INSTRUCTIONS '15-'19 DODGE RAM SSV

## \*Rear Window Steps



Fold rear seat upwards to remove the (8) 18mm bolts from the underside of seat. Disconnect Speaker and set aside.

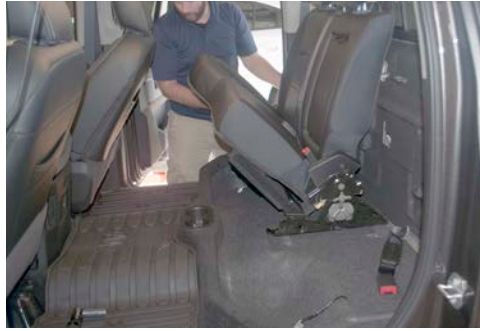

Lift rear seat upward to allow it to unhook from the rear latch. Set seat aside.



Remove (3) 13mm OEM bolts from child restraint loops.



Loosely attach Lower Brackets into place using the previously removed (3) 13mm OEM bolts. You will need to remove ring from child restraint loops to retrieve bolts.



Remove "C" pillar upper OEM trim by first removing phillips screw from behind plastic clip. Then carefully pull trim away from frame. You will need to separate the upper trim from lower trim and set aside.



Before installing Side Mount Brackets, you will need to pry the wire loose from OEM frame down to lower trim on C Pillar.

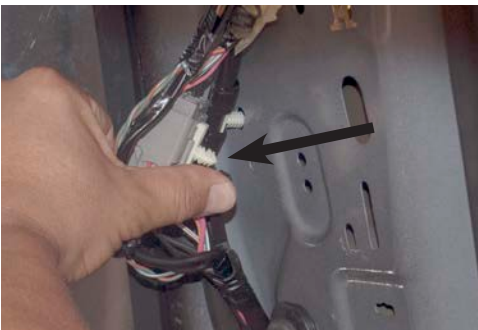

Then remove the white clip from plug.

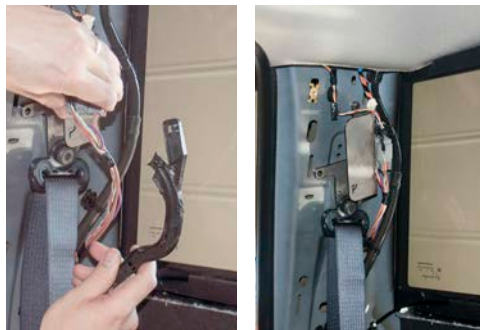

Remove plastic channel from lower section of wire. Once bracket is in position, wire will set between bracket and rear window.

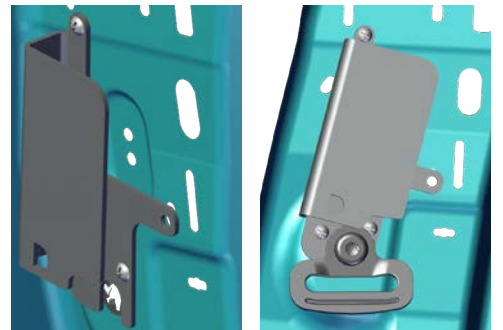

Using the slot on bracket, slide behind seat belt bolt and use the hole closest to door jam and align with OEM hole. Once in proper position secure Side Mount Brackets to frame using provided (3) tek screws.



# WINDOW ARMOR INSTALLATION INSTRUCTIONS '15-'19 DODGE RAM SSV



Replace OEM "C" pillar trim and tighten the (3) Lower Brackets



Secure Rear Window Armor to all brackets using provided (3) flange nuts on Lower Brackets and (6) tek screws on Side Brackets. Once Window is in position, tighten all hardware.

## \*Door Window Armor Steps

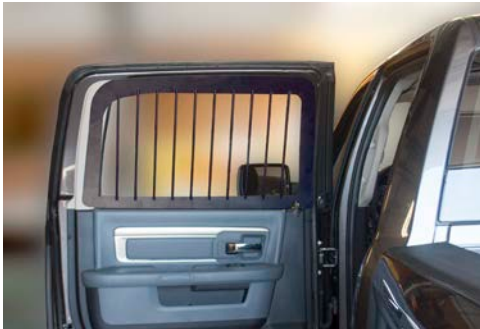

Align Door Window Armor into position following contour of door frame. Secure Window Armor into place using provided tek screws.

